

UV Garden Parasol

INSTRUCTION MANUAL

Model No. EL4844

Please read carefully before use and keep for future reference

Parts

- Main Body
- Handle

How to Assemble

- Screw the stem of the main body into the Handle. (1)
- Twist the winder on the handle anti-clockwise to open the chair clamp and attach to the chair. (2)
- Twist the winder clockwise until Parasol is secure (3)

How to adjust the Angle

- The Parasol can be adjusted 180° by pressing the button located at the side and gently pulling until in required position. Do not force the Parasol as this could break it. (4)

To Open

- Simply push the button at the side of the Parasol to open. (5)
- Warning: The Parasol opens quickly, please avoid being too close at the point of opening.

Cleaning

- Wipe Parasol clean with a soft damp cloth. Wipe Handle and body with a soft dry cloth.

Disposal

- Please respect the environment!
- Dispose of the packaging according to the local recycling regulations
- Dispose of the appliance at the end of its life span according to environmental considerations

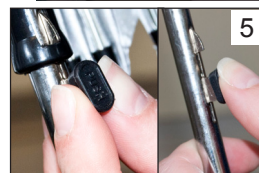
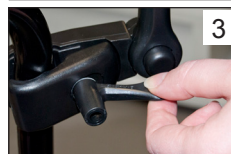

WARNING

Measurements: 97.8x4.5cm Diameter when open – 105cm
Material: Metal, PP and Pongee

Imported and distributed by Easylife Group Ltd, London NW1 0JP

Support Line: 0333 030 0777

For more innovative products from Easylife please visit:

www.easylifegroup.com



easylife[™]
Est. 1992 everyday solutions