

4 In 1 Pest Repeller

INSTRUCTION MANUAL

Model No. 2660 (ZT09034)

Please read carefully before use and keep for future reference

- A. Night Light
B. Ultrasonic Speaker
C. Indicator Lights
D. Night Light Switch

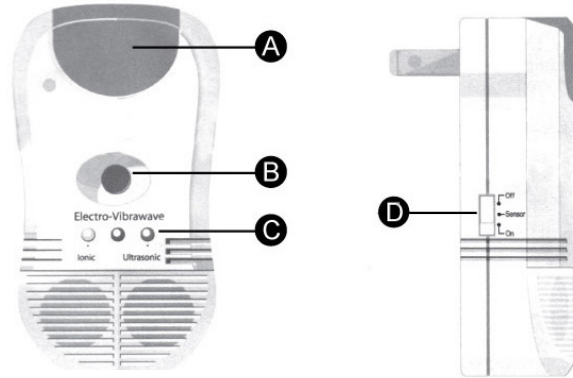

INSTRUCTIONS FOR USE

Remove the Pest repeller from its packaging. Plug your Pest repeller into an available wall socket. We recommend plugging it into the socket closest to where you are seeing the pest problem. If you are currently not seeing any pests, plug your Pest repeller in a central area.

When you plug the Pest repeller in, the three Indicator Lights (C) on the front of the unit will light up, letting you know that all three pest control technologies are functioning properly.

- The Orange Light will stay on constantly----indicating the Ionic feature is working.
- The Red Light will flash slowly----indicating the Electro-Vibrowave technology is working.
- The Green Light will flash rapidly ----indicating the Ultrasonic sound is working.

If you purchase multiple Pest repeller units, place them evenly throughout the building. We recommend at least two per floor in your home or building.

To adjust the Night Light (A), locate the Night Light Switch (D) on the left side of the unit. You may set the Night Light to either "Off", "Sensor" or "On".

- "Off " disables the Night Light.
- "Sensor " activates the Night Light only when the lights in the room are turned off.
- "On" keeps the Night Light turned on all day and night.

FEATURES

ULTRASONIC PEST CONTROL

Generates a powerful high pressure sound inaudible to humans and pets, yet as loud as a siren to insects and rodents. Pests get pounded by the daunting sound and flee.

IONIC PEST CONTROL

Pumps out beneficial negative ions that clean the air of pollutants and food odors that attract pests. Ionic technology has been used for years in the air purification industry.

ELECTRO-VIBRAWAVE PEST CONTROL

Surges digitally-processed magnetic vibrations through the wiring deep within your walls where pests nest and breed. Transforms your home into an uninviting, hostile environment for pests.

NIGHT LIGHT

The energy-conserving blue LED night light automatically illuminates dark corners and hallways with a soft glow.

IMPORTANT SAFETY INSTRUCTIONS:

WARNING: INSTRUCTIONS PERTAINING TO RISK OF FIRE, ELECTRIC SHOCK, OR INJURY TO PERSONS
WARNING - WHEN USING ELECTRIC APPLIANCES, BASIC PRECAUTIONS SHOULD ALWAYS BE FOLLOWED, INCLUDING THE FOLLOWING:

READ ALL THE INSTRUCTIONS BEFORE USING THE APPLIANCE.

- To reduce the risk of injury, close supervision is necessary when an appliance is used near children.
- Do not contact moving parts.
- Never open the device. There are not any serviceable parts inside. Please refer servicing to a qualified service personal.
- Do not use outdoors.
- To reduce the risk of electrical shock, do not put it in water or other liquid.
- Do not place or store appliance where it can fall or be pulled into a tub or sink.

IMPORTANT NOTES

- The ultrasonic sound emitted by the Pest repeller can travel up to 5,000 sq.feet in an open area(such as a warehouse).
- For optimum coverage,plug a unit in each room without anything blocking or covering the device.
- Do not place the Pest repeller behind solid obstructions like furniture or draperies
- Do not place the Pest repeller outside where it can get wet.
- It is normal to see a slight increase in the amount of pests during the first two weeks after installation.
The pests are simply being flushed out of the walls and their hiding places,and will soon disappear altogether
- The Pest repeller is designed to be safe around humans,pets,and household electronics.
- Do not use in the same area as pet rodents.
- Do not clean the device when it is plugged in the socket. Unplug the device, leave it for 10 minutes and clean with soft cloth.

SPECIFICATIONS

- Ultrasonic Sound Distance---up to 5,000 sq.ft.(sound will not penetrate solid barriers)
- Size: 12.4x7x4.5 CM
- Weight: 198g
- Power: 220V-240V/50Hz
- Power consumption: 8W Max

FREQUENTLY ASKED QUESTIONS

Does the Pest repeller require any adjustments or maintenance?

The Pest repeller is 100% maintenance free. As soon as you plug the device into your wall, it goes to work for you!

Is the Pest repeller safe to use around people and small children?

The Pest repeller is designed to be perfectly safe to use around people of all ages, including small children. All pest control technologies included in the Pest repeller are designed to be safe,humane and environment friendly.

Will it bother or harm my pets?

The Pest repeller is designed to be perfectly safe to use around most household pets and animals,such as cats, dogs, fish, reptiles,birds,livestock and more. Do not use the Pest repeller in the same room with rodent pets such as Hamsters, Mice, Gerbils, Rats, Chinchillas, Ferrets, Guinea Pigs, Prairie Dogs and Rabbits. Rodent pets will be bothered by the sounds released by the Pest repeller.

Can the Pest repeller be used around household electronics?

The Pest repeller is designed to be safe for use around common household electronics such as stereos,TVs,computers,and kitchen appliances. We do however recommend you consult an electrician before using the Pest repeller around custom electronic systems such as "X-10" home writing.

Will the sounds emitted by the Pest repeller go through solid objects such wall, floors, or ceilings?

The ultrasonic sound released by the unit will not go through solid barriers such as walls,but will instead bounce off them. We recommend keeping the doors open in the rooms of your house or office as much as possible to allow the sound to travel as far as possible

DISPOSAL

- Please respect the environment!
- Dispose of the packaging according to the local recycling regulations.
- Dispose of the appliance at the end of its life span according to environmental consideration

Easylife Ltd, London, NW1 0JP

Tel: 020 3455 0199

© Easylife Ltd. 2021 (Reg. No. 05221840)

For more innovative products, please visit

www.shopgoodideas.com



good Est. 1975
ideas™
smarter living