



Mini Rechargeable Digital Hearing Device

QUICK START MANUAL

Model No. EL12345

Please read carefully before use and keep for future reference

BEFORE FIRST USE PLEASE CHARGE THE HEARING DEVICE FOR 8 HOURS.

INSERTING HEARING DEVICE FOR CHARGING:

1. Open lid and check that the metal pins are free from Debris
2. Insert the hearing device into the charging base at an upright angle
3. Push the tip of the hearing device forward so that it rests on the charging unit
4. Close the lid and test using the method below to ensure the hearing device is charging

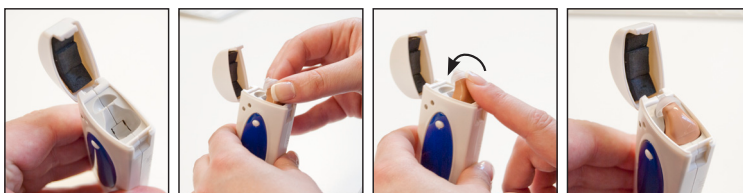

Please note:

Do not remove the black foam from the top of the case.

If you have followed this process and only one light comes on, please open the lid of the charging case and push the hearing device down. If both lights are not on, the hearing device is not charging.

Pressing Status Testing Button once, both indicator light 1 and 2 are illuminating green:	Pressing status testing button once - Indicator light 2 illuminates green:	Pressing status testing button once - Indicator light 2 illuminates red:	Pressing status testing button once, both Indicator light 1 and 2 don't illuminate:
This means the hearing aid is charging.	This means either charging is completed, or the Hearing Aid has not been correctly inserted.	AA battery has run out of the power. Replace battery or charge via AC adaptor supplied.	There is no power supply connected so either install the alkaline battery or connect the AC adaptor.

TO CHARGE USING AN ALKALINE BATTERY

Ensure that the hearing device dial is set to HIGH. Insert the battery. Place hearing device into the case ensuring that you push it all the way down and close the lid. To ensure that the hearing device is charging press the button in the middle of the charging case. Both lights should come on. If they do not the hearing device is not charging and you need to push the device down into the charging case.

TO CHARGE USING A MAINS POWER SOURCE

Ensure that the hearing device dial is set to HIGH. Insert the supplied charger into the side of the charging case. Place hearing device into the case ensuring that you push it all the way down and close the lid. To ensure that the hearing device is charging press the button in the middle of the charging case. Both lights should come on. If they do not the hearing device is not charging and you need to push the device down into the charging case.

FITTING THE HEARING DEVICE

Choose the correct size Ear Cap and attach to the hearing device. Insert into the ear, ensuring the microphone is blocked by your finger. If you do not cover the microphone you will hear loud buzzing sounds.

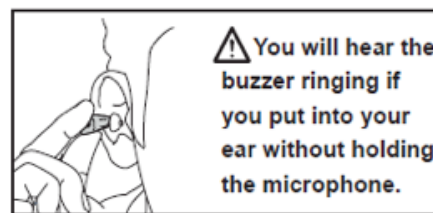
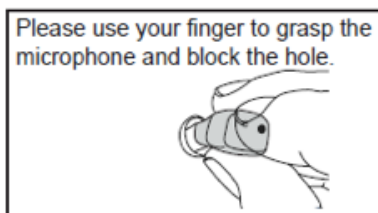

Move the hearing device around until fitted comfortably.

Imported and distributed by Easylife Group Ltd, London NW1 0JP
Support Line: 0303 031 0777
 For more innovative products from Easylife please visit:
www.easylifegroup.com